

# TATOO



## Fianchi a Vista FINISHING SIDES COTES FINIS



Seta



Tortora



Bianco



Fango



Pietra



Nube

## Struttura STRUCTURE STRUCTURE

> > > >



Bianco  
WHITE \_ BLANC



Creta

## Zoccoli PLINTHS SOCLES

> > > >

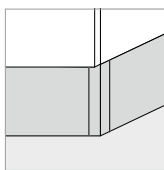

Zoccolo h. 15 cm  
h. 12 cm a richiesta  
PLINTH H. 15 CM  
H. 12 CM ON REQUEST  
SOCLE H. 15 CM  
H. 12 CM SUR DEMANDE

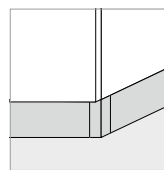

Zoccolo h. 8 cm  
PLINTH H. 8 CM  
SOCLE H. 8 CM

## Sistemi di apertura OPENING SYSTEMS SYSTEMES D'OUVERTURE

> >

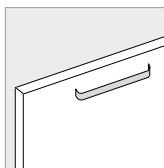

Maniglia esterna  
EXTERNAL HANDLE  
POIGNÉE EXTERIEURE

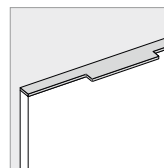

Maniglia bordo anta  
HANDLE EDGE ON DOOR  
POIGNÉE SUR CHANT DE PORTE

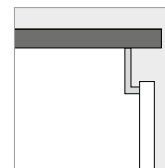

Gola  
GROOVE  
GORGE

**Ante Vetro**  
GLASS DOORS  
PORTES VITRES



**Telaio alluminio satinato**  
SATINATED ALUMINIUM FRAME  
CADRE ALUMINIUM SATINE



**Telaio alluminio satinato**  
SATINATED ALUMINIUM FRAME  
CADRE ALUMINIUM SATINE



**Telaio alluminio spazzolato**  
BRUSHED ALUMINIUM FRAME  
ALUMINIUM BROSSE CADRE

**Ante**  
DOORS . PORTES



Spessore 1,8 cm, realizzate in nobilitato E1 idrorepellente V100, bordate in ABS  
spessore 0,1 cm

1,8 CM THICK, WATER REPELLENT V100 MELAMINE CHIPBOARD, E1 CLASS, ABS RIMMED  
0,1 CM THICK.

EPAISSEUR 1,8 CM, REALISEE EN PANNEAU DE PARTICULES DE BOIS REVETUE EN STRATIFIE FENIX NTM.  
BORDEE EN UNICOLOR FENIX EPAISSEUR 0,1 CM



Bianco



Fango



Pietra



Nube